

F

CLASS





EXPERIENCE THE
EXCEPTIONAL

Your yacht is an extension of yourself. A statement of your lifestyle. She needs to deliver unforgettable experiences for you, your family and friends. Every Princess yacht is designed with our forward-thinking mentality and crafted with meticulous attention to detail. So whether you're dashing across the water or moored in your favourite bay, you will recognise the difference our design and details make, inside and out.

Experience the exceptional.



CRAFTED IN PLYMOUTH

Perched on the edge of the English Channel lies the city of Plymouth, where we established our home in 1965. Today Princess shipyards cover an area of over 1.1 million square feet, an area rich in British maritime heritage. In fact, South Yard, where our X Class Super Flybridge yachts are constructed, is a former naval yard dating back to the 17th century. From the outset, our goal has been to meticulously sculpt our yachts around our owners' enjoyment of them. Such dedication and attention to detail resonates deeply with our Plymouth craftspeople.

Over 3,000 people, each possessing a mastery of their skill, fastidiously realise this vision in our shipyards. Through a culture of innovation, our yachts are not only some of the most technically-advanced in the world but also the most beautifully realised.



BEAUTY IS ALWAYS IN THE DETAIL

We are determined to develop ever more ingenious ways to ensure every last millimetre of your boat is ergonomically sound, highly practical, and spatially perfect. Once our team of naval architects, designers and engineers have determined a design, our craftspeople fastidiously bring it to life. Every beautiful detail is crafted and finished within our Plymouth shipyards. This enables us to consistently monitor quality throughout each build. Seeing is believing though, so we invite future owners to pay us a visit and see beauty in progress through their own eyes.





F CLASS

Experience the most technically advanced and spaciouly proportioned flybridge yachts on the water. Every Princess flybridge yacht rewrites the rule book on space, performance and entertaining. Wonderfully progressive, incredibly efficient, classically Princess.



F 65



The all-new F65 boasts a contemporary use of layout featuring the latest geometric design elements. Focussed around a sociable use of space she provides accommodation for eight guests across four cabins. Vast panoramic saloon windows and signature wrap around front screens offer uninterrupted vistas from the main deck whilst elongated hull windows generously flood her accommodation areas with light. The expansive main deck is segmented into an aft galley with dinette, saloon with large U-shaped sofa plus companion seating opposite the helmsman area which features a side access door to the deck.







The foredeck provides the perfect spot to enjoy outdoor relaxation with split sunpads and the ability to include an integrated cool box.

Her contemporary flybridge is the perfect outdoor entertaining area, with ergonomic dining seating, wetbar with barbecue, coolbox and sink, plus an aft sunbed and L-shaped companion seat with infill as a secondary sunbed.



TAKE A VIRTUAL TOUR OF THE F65



EXPERIENCE THE F65





F 65
SPECIFICATION

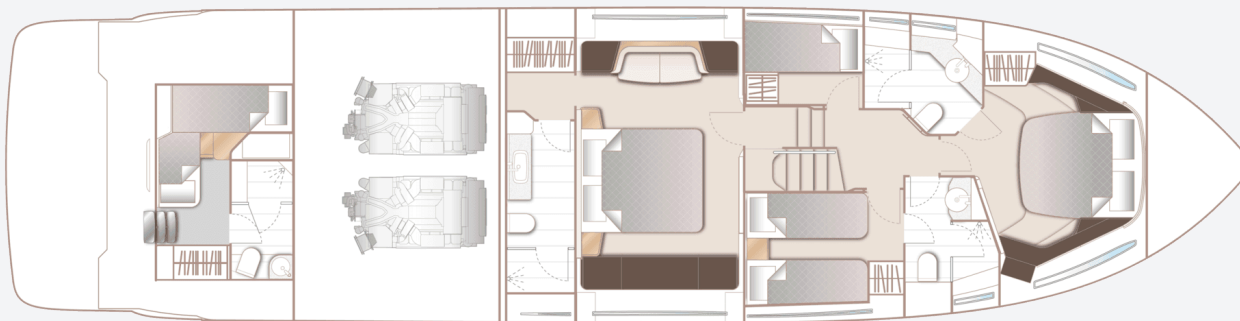
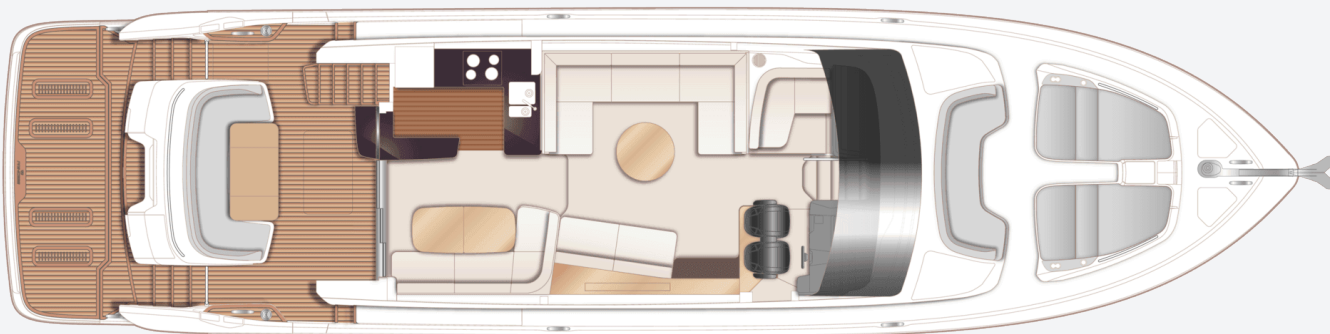
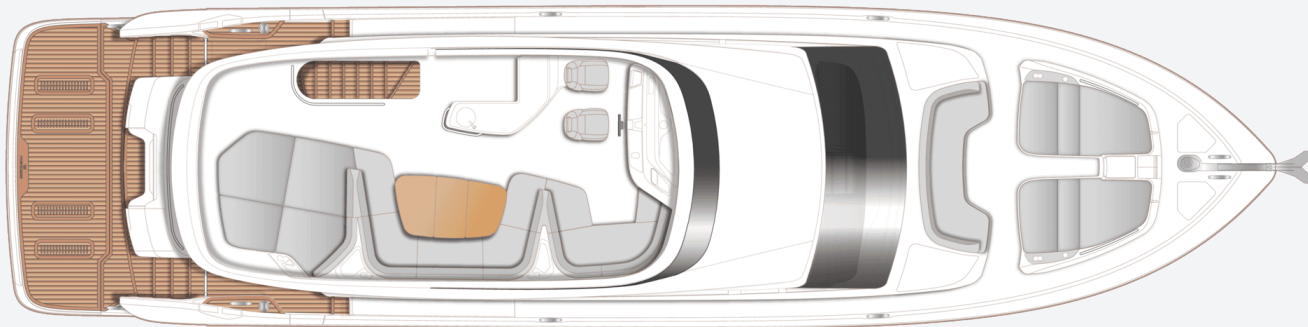

PRINCIPAL DIMENSIONS

Length overall (incl. pulpit)	66ft 7in (20.30m)
Length overall (excl. pulpit)	65ft 8in (20.03m)
Beam	16ft 9in (5.10m)
Draft	5ft 4in (1.63m)
Displacement approx. (lightship)	40,177kg (88,575lbs)*
Fuel capacity	902 gal/1,083 US gal/ 4,100l
Water capacity (excl. calorifier)	172 gal/211 US gal/ 800l

ENGINES

Twin MAN V8 1200 (2 x 1,200hp)	Speed range: 31-33 knots†
---------------------------------------	------------------------------

FULL SPECIFICATION

DECK FITTINGS

- Teak-laid transom platform, transom steps, cockpit deck, flybridge stairway and steps to side deck
- Reversible electric anchor winch with foredeck and helm position controls
- Stemhead roller with automatic anchor launch and retrieve
- Self-stowing anchor system incorporating one Lewmar Delta anchor (40kg/88lb) with 60m of 9.5mm chain
- Bow rope storage locker
- Freshwater deck/anchor wash
- Deck storage lockers for fenders
- Stainless steel forward fairleads (2)
- Stainless steel stern fairleads (2)
- Cast stainless steel bow, stern and spring cleats (8)
- Stainless steel pulpit and guardrails (32mm round)
- Stainless steel coachroof handrails
- PVC rubbing band with stainless steel insert
- LED deck level lighting

- Illuminated crown logo on transom
- Full set of IMCO navigation lights
- Riding light
- Searchlight with remote control
- Loudhailer (connected to VHF)
- Twin electric horns
- Fuel and water fillers
- Foredeck escape hatch
- Walk through foredeck seating area
- Foredeck sunbathing area with twin sunbeds including cushions with integrated storage and drinks holders (4)

COCKPIT AND BATHING PLATFORM

- Self-draining cockpit
- U-shaped seating/dining area with folding teak table and drinks holders
- Upholstered cockpit headlining panels
- LED overhead and deck level lighting
- Integral stairway to flybridge
- Stainless steel handrails
- Liferaft stowage locker
- Rope stowage lockers

- Starboard lightweight pantograph door for access to lazarette/optional crew cabin
- Lockable gas strut assisted hatch to secondary port side lazarette
- Lockable gas strut assisted hatch to engine room
- Lockable wet locker accessed from port side transom hatch (accepts optional SEABOB (x2) storage and charging rack)
- Locker containing remote fuel cocks, manual bilge pump with valve chest and manual controls for automatic fire extinguishers
- Twin transom doors leading to bathing platform
- Transom seat in teak
- Ensign socket and transom grab rail
- Electro-hydraulic raise/lower teak laid bathing platform (500kg SWL)
- Retractable bathing ladder (manual) in side of hydraulic platform
- Transom steps to access stern from bathing platform when in lowered position
- Hot and cold transom shower
- 220/240v shore support inlet in locker

- Cockpit cover

FLYBRIDGE

- Dual station instrumentation and controls (see Helm Position)
- Drinks holders (2) and storage locker tray
- 16" colour multifunctional display screen incorporating GPS/chartplotter, log and echo sounder
- 9" multifunctional display screen incorporating engine instrumentation (including fuel levels and fuel flow)
- Adjustable steering wheel
- Audible and visual alarm for bilge pumps
- Wind deflector screens (grey tinted perspex)
- Separate helm and navigator seats with fore and aft adjustment for helmsman
- L-shaped upholstered companion seating area with infill for conversion to sunbed (storage for infill below)
- Storage tray behind flybridge L-shaped seating with drinks holders
- U-shaped upholstered seating area and storage below
- Storage tray behind flybridge U-shaped

- seating with drinks holders
- Teak dining table with removable leaf
- Walkaround sunpad aft, drinks holders and storage below
- Fusion Apollo MS-SRX400 audio system paired with Fusion Signature 7.7" waterproof speakers (2)
- L-shaped wetbar including sink with electric barbecue, top loading coolbox and waste bin
- Clear view hatch to aft cockpit
- Stainless steel handrails
- LED deck level lighting
- GRP radar arch
- Matched whip aerials for VHF R/T and radio
- Console, seat, wet bar and table covers
- Optional GRP hardtop with/without electric opening section (or optional folding bimini with optional electro-hydraulic operation)
- USB-A charging point (2)

HELM POSITION

- Twin helm seats with fore and aft adjustment for helmsman, F-logo to helm seat, flip up base to helm seat for door access

- Instrument console with controls incorporating engine instruments and fuel gauges
- Dual station instruments and controls at Flybridge and Lower Helm Positions:
 - 16" colour multifunction display incorporating GPS/chartplotter, log, echo-sounder
 - 9" multifunction display screen incorporating engine instrumentation (including fuel levels and fuel flow)
 - power-assisted electro-hydraulic steering
 - adjustable steering wheel
 - rudder position indicator
 - high-speed magnetic compass
 - electronic engine controls
 - trim tab controls with indicators
 - bow thruster control
 - electric anchor winch remote control
 - autopilot
 - VHF with DSC R/T with intercom
 - remote control searchlight
 - horn button
- Drinks holders
- Small storage tray
- Toughened glass screen (clear for night vision)
- Windscreen wipers with freshwater windscreen wash

- Exterior black mesh sunscreens
- Bilge pump controls with visual pump running warnings
- 24v and 240v electrical control panel
- Riding light, helm and navigation light control switches
- USB charging points (4)
- 220/240v outlet (1)
- LED overhead lighting (24v) and night lighting
- Pantograph helmsman's side door to starboard side deck
- Fitted carpet

SALOON

- U-shaped sofa with storage drawers
- Coffee table
- Two-seater sofa with storage
- L-shaped seat with storage opposite helm area
- Electric opening window to port
- Bottle and glass storage below helm seat
- Sideboard with refrigerator (80l)
- 55" TV on rise and fall
- Fusion Apollo MS-RA770 audio system paired with Focal 100ICW6 speakers (2)
- Manual tension venetian blinds to all

- windows and doors
- LED overhead and concealed lighting (24v)
- Access stairway to lower accommodation
- Fitted carpet
- 220/240v outlets (2)

DINING AREA

- L-shaped sofa
- Folding dining table/drinks holders and crockery drawer
- Stainless steel framed sliding door to cockpit, three panes with integrated hinging window aft of galley (one fixed pane, one sliding pane, one flip up window) and integrated Skysol blinds
- Manual tension venetian blinds to windows
- LED overhead and concealed lighting (24v)
- Fitted carpet
- 220/240v outlets (2)

GALLEY

- Solid surface countertop
- 4-zone ceramic hob
- Hob extractor fan
- Combination microwave/convection oven with grill
- Full height fridge/freezer (281l)

- 1.5 bowl solid surface sink with mixer tap
- Waste bin
- Drawers and storage cupboards
- Manual tension venetian blinds to windows
- LED overhead and task lighting (24v)
- 220/240v outlets (4)
- Timber flooring (V-groove planked)

ACCOMMODATION

- All cabins and bathrooms (excluding crew bathroom) feature opening portholes
- All cabins feature 220/240v power points
- All bathrooms (excluding crew bathroom) feature 240v shaver points
- All bathrooms feature electric freshwater toilets

OWNER'S STATEROOM

- Large double bed with drawers below
- Twin bedside tables
- Walk-through wardrobe area with hanging, drawer storage and full-length mirror
- Dressing table
- Sofa
- Storage lockers and drawers
- 43" TV
- Fusion Apollo MS-RA770 paired with Focal

- 100ICW6 speakers (2)
- Panoramic windows including opening porthole
- Manual tension venetian blinds
- LED overhead and concealed lighting (24V)
- Individual berth lights
- 220/240v outlets (4)
- USB charging point (4)
- Fitted carpet

EN-SUITE BATHROOM

- Wash basin with solid surface vanity top
- Mirror to vanity unit
- Storage lockers
- Shower compartment with automatic pump out
- Extractor fan
- Window with opening porthole
- Manual tension venetian blind
- LED overhead lighting (24v)
- Bathroom accessories
- Solid Surface flooring

FORWARD STATEROOM

- Large double bed with drawers below
- Wardrobe with shelves and full-length mirror

- Dressing table
- Storage lockers
- Windows with opening portholes
- Manual tension venetian blind
- Deck hatch
- LED overhead lighting (24v)
- Individual berth lights
- 220/240v outlets (3)
- USB charging points (4)
- Fitted carpet

EN-SUITE BATHROOM

- Washbasin with solid surface vanity top (thermo-formed)
- Mirror
- Storage lockers
- Shower compartment with automatic pump out
- Extractor fan
- Window with opening porthole
- Manual tension venetian blind
- LED overhead lighting (24v)
- Bathroom accessories
- Solid surface flooring

STARBOARD GUEST CABIN

- Two single beds with drawers below (with option of sliding double bed conversion)
- Bedside table
- Wardrobe with shelves
- Mirror
- Storage lockers and drawers
- Window with opening portholes
- Manual tension venetian blind
- LED overhead lighting (24v)
- Individual berth lights
- 220/240v outlet (1)
- USB charging points (2)
- Fitted carpet

EN-SUITE BATHROOM

- Wash basin with solid surface vanity top (thermo-formed)
- Mirror
- Storage lockers
- Shower compartment with automatic pump out
- Extractor fan
- Window with opening porthole
- Manual tension venetian blind
- LED overhead lighting (24v)

- Bathroom accessories
- Solid surface flooring
- Day access door from lower lobby

PORT GUEST CABIN

- Two single beds
- Wardrobe with shelf
- Mirror
- Storage lockers
- Window with opening portholes
- Manual tension venetian blind
- LED overhead lighting (24v)
- Individual berth lights
- 220/240v outlet (1)
- USB charging points (2)
- Fitted carpet

LOBBY AREA

- Combination washer /dryer with storage area above located below companionway stairs (option of separate washing and drying machines if required)
- Fitted carpet
- LED overhead and concealed lighting (24v)

OPTIONAL CREW CABIN (IN PLACE OF AFT LAZARETTE)

- Furniture in specified choice of boat timber
- Single bed with storage below (optional second bunk available)
- Lockers with shelf
- Mirror
- Opening porthole
- Transom glazing with venetian blind
- Lightweight pantograph door with access from transom
- LED overhead lighting (24v)
- Individual berth lights
- 220/240v outlet (1)
- USB Charging points (2)
- Fitted Carpet
- En-suite bathroom
- Bathroom in white laminate
- Washbasin with solid surface vanity top
- Storage lockers
- Shower with automatic pump out
- Extractor fan
- LED overhead lighting (24v)
- Bathroom accessories
- Solid Surface flooring

POWER AND DRIVE SYSTEMS

- Propeller shafts in Marinemet
- 5-bladed propellers in nickel aluminium bronze
- Bow thruster (170kgf/375lbf) with dual-station controls
- High speed balanced rudders
- Power-assisted electro-hydraulic steering system
- Trim tabs with indicators
- Cathodic protection for sterngear
- Sterngear, engines, fuel tank fillers, etc all electrically bonded
- Forward and aft engine room bulkheads and engine room headlining to be integrally bonded including insulation with acoustafoam layers
- High volume air intakes
- Engine room extractor fan with electronic time delay
- Engine exhaust silencers and water-cooled exhausts
- Engine beds integrally moulded with hull for strength and vibration absorption
- Engines flexibly mounted
- Automatic fire extinguisher with remote

override control

- Automatic and manual bilge pumps
- Engine room lighting
- Engine room access hatch and ladder
- Electronic engine and gear shift controls
- Fresh water supply point in engine room
- Dripless self-aligning shaft seals

ELECTRICAL SYSTEMS

24 Volt:

- 4 x heavy duty batteries for engine starting
- 4 x heavy duty auxiliary batteries
- Battery link facility with remote control at helm position
- Both battery banks are charged using a voltage sensitive relay that parallels both battery banks when a charging source is present
- 80-amp battery charger charges both banks of batteries via an automatic switch charging system
- 6-amp battery charger for generator battery
- Remote battery master switches with control switch at main switch panel
- Circuit breakers on all circuits
- 12v voltage dropper for certain navigation

and radio circuits

220/240 Volt:

- 11 kW diesel generator in own sound shield with water cooled specially silenced exhaust
- Automatic fire extinguisher situated by generator
- 60-amp shore support inlet
- 6-amp battery charger for generator battery
- Generator/shore support change-over switch
- Polarity check system
- Earth leakage safety trip
- Circuit breakers on all circuits
- Power points in: Owner's stateroom, guest cabins, galley and saloon area
- Shaver points in all bathrooms (excluding crew)

FUEL SYSTEM

- Twin fuel tanks (in NS8 marine grade alloy) with interconnection system giving 902 gal/1,083 US gal/4,100l capacity
- Fuel fillers on port and starboard side deck steps
- High-capacity duplex fuel filters with water

traps with change-over valves, water warning sensors connected to warning lights at lower helm

- Remote fuel cocks in cockpit locker
- Fuel gauges at main helm console (via multifunctional display)

WATER SYSTEM

- Water tanks totalling 176 gal/211 US gal/800l plus 16 gal/19 US gal/73l hot water calorifier
- Water heated by engines and 240v immersion heater
- Automatic water pump with filter
- Main circuit breaker at switch panel
- Water level gauge
- Deck filler
- Electric freshwater toilet system with 60 gal/72 US gal/272l holding tank, content gauge and manual overboard discharge, with macerator backup system as well as dockside discharge system

FIRE EXTINGUISHERS

- Automatic/manual override fire extinguishers in engine room with warning system at helm position
- Hand-operated fire extinguishers (6) in owner's stateroom, forward, port and starboard guest cabins, galley and helm position
- Additional extinguisher fitted when optional aft cabin is specified

BILGE PUMPS

- Automatic/manual override electric bilge pumps in engine room (2), rudder area, lazarette and forward accommodation (6 in all)
- High-capacity manual bilge pump with valve system and suction points in same areas
- Electric bilge pumps have controls and warning lights at main helm and warning light with audible alarm at flybridge helm

OTHER STANDARD EQUIPMENT

- Ensign staff
- Fenders (6)
- Mooring warps (4)

- Boat hook
- First-aid kit
- Tool kit
- Owner's manual and engine manual
- Functional bed linen (fitted bottom sheet, loose top sheet and oxford pillowcases) supplied to all cabins (including optional crew cabin, where specified)
- Set of glassware (8 settings consisting of tumbler and wine glasses)
- Set of Princess china (8 settings consisting of plate, side plate, bowl, cup and saucer)
- Set of cutlery (8 settings of David Mellor "Paris" cutlery 7 pieces)
- Ship's document case
- Anchor winch back up handle
- F65 canopy badges

FINISHES

- Teak-laid transom platform, transom steps, steps to side decks, cockpit deck and steps to flybridge
- Timber-laid floor (V-groove planked) to galley area and dining area
- Furniture in choice of Rovere Oak or Alba Oak in satin finish as standard. Silver Oak or

- Walnut in satin or gloss finish available as an option
- Solid surface floors in all bathroom suites in guest accommodation
- Solid surface wash hand basin vanity tops in all bathrooms
- Galley countertop in solid surface finish
- Choice of high-quality carpet and upholstery fabric from extensive range
- Exterior upholstery in white vinyl as standard, with optional upgrade to Comfort Exterior available
- Manual venetian blinds to all windows and portholes
- Optional crew cabin furniture in specified boat timber with fitted carpet. Crew bathroom has white solid surface vanity tops and floors

F 55



Equipped with twin Volvo D13-900 engines providing speeds up to 33 knots, in addition to a deep-V resin-infused hull, the F55 delivers dynamic and effortless seakeeping. As seen on larger yachts in the range, the cockpit servery unit connects to the galley unit, seamlessly integrating the two entertainment areas. The spacious main deck saloon is accentuated by vast saloon windows, complemented by subtle accent lighting, soft fabric finishes and hand-stitched detailing. A contemporary U-shaped sofa with convertible coffee/dining table and sofa adjacent, creates the perfect place to spend time with loved ones.





Below deck, new expansive hull windows generously flood the three cabins with light, including the master stateroom with dressing table, breakfast area and en-suite bathroom, a forward double guest cabin and starboard twin cabin with the option of a double bed conversion. An optional single aft cabin with en-suite and storage is ideal for crew.





TAKE A VIRTUAL TOUR OF THE F55





F55
SPECIFICATION

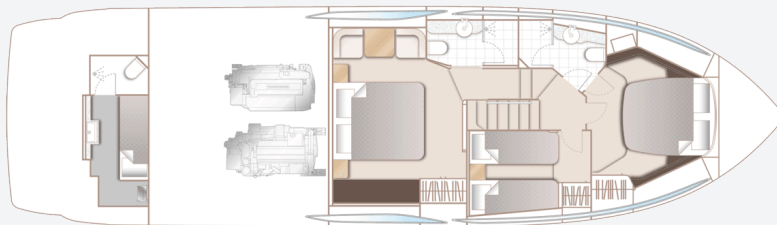
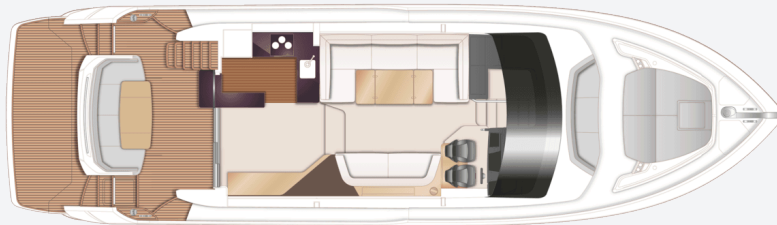
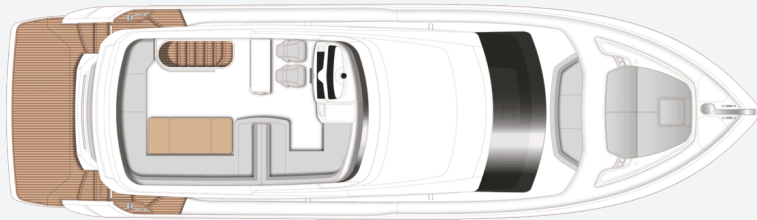

PRINCIPAL DIMENSIONS

Length overall (incl. pulpit)	58ft 0in (17.68m)
Length overall (excl. pulpit)	55ft 8in (16.98m)
Beam	16ft 0in (4.87m)
Draft (at full load) approx.	4ft 7in (1.41m)
Displacement approx.	30,924kg (68,176lbs)*
Fuel capacity	605 gal/726 US gal/2,750l
Water capacity (excl. calorifier)	136 gal/164 US gal/620l

ENGINES

Twin Volvo D13-900 (2 x 900mhp)	Speed range: 32-34 knots†
--	---------------------------

FULL SPECIFICATION

DECK FITTINGS

- Teak-laid transom platform, cockpit deck, flybridge stairway and steps to side deck
- Reversible electric anchor winch with foredeck and helm position controls
- Stemhead roller with automatic anchor launch and retrieve
- Self-stowing (25kg/55lb) galvanised Lewmar Delta anchor with 40m of galvanised 9.5mm anchor chain
- Bow rope storage locker
- Freshwater deck/anchor wash
- Walk through coachroof seating area
- Foredeck sunbathing area
- Deck storage locker for fenders and ropes
- Stainless steel bow, stern and spring cleats (8)
- Stainless steel pulpit and guardrails
- Stainless steel coachroof handrails
- Foredeck hatch
- PVC rubbing band with stainless steel insert
- LED deck level lighting
- Illuminated crown logo to transom
- Full set of IMCO navigation lights

- Riding light
- Searchlight with remote control
- Twin electric horns
- Loudhailer
- Fuel and water fillers

COCKPIT AND BATHING PLATFORM

- Self-draining
- U-shaped seating/dining area with folding teak table
- LED overhead and deck level lighting
- Stainless steel handrails
- Rope stowage locker
- Lockable gas strut assisted hatch to lazarette/engine room
- Lockable gas strut assisted hatch to lazarette/optional crew cabin
- Locker containing remote fuel cocks, manual bilge pump with valve chest and manual controls for automatic fire extinguishers
- Twin transom doors leading to bathing platform
- Retractable bathing ladder (manual) in side of bathing platform

- Transom steps to access stern from bathing platform when in lowered position
- Hot and cold transom shower
- 220/240v shore support inlet in locker
- Cockpit cover

FLYBRIDGE

- Dual station instrumentation and controls with 16" Garmin screen displaying engine instrumentation, fuel gauges, rudder position indicator and chartplotter (either individual or combined)
- Adjustable steering wheel
- Top loading coolbox adjacent to helm
- Audible and visual alarm for bilge pumps
- Twin helm seats with fore and aft adjustment for helmsman
- U-shaped upholstered seating starboard fore (converts to sunbed)
- U-shaped upholstered seating area starboard aft
- Teak folding table
- Fusion MS-SRX400 audio system with

waterproof Fusion signature 6.5" speakers

linked to saloon audio unit

- Wetbar including sink, stowage and optional electric barbecue
- Clear view hatch to aft cockpit
- Wind deflector screens
- Stainless steel handrails
- Stainless steel handrail forward of flybridge hatch
- LED deck level lighting
- GRP radar arch
- Matched whip aerials for VHF R/T and radio
- Liferaft stowage
- ROKK twin USB socket
- Console and seat covers
- Optional GRP hardtop with/without electric opening section (or optional folding bimini with optional electro-hydraulic operation)

LOWER HELM POSITION

- Twin helm seats with fore and aft adjustment for helmsman
- Instrument console with 16" Garmin screen displaying engine instrumentation, fuel gauges, rudder position indicator and chartplotter (either individual or combined)

- Volvo engines have a 7" display for engine instrumentation at both control positions. The 16" screen incorporates Volvo software to allow engine instrumentation and autopilot function displays, as well as the 7" display. If a second 16" screen is ordered it will be fitted immediately in front of the helm position with the engine instrumentation display to starboard.
- Dual station instruments and controls at Flybridge and Lower Helm Positions:
 - power-assisted electric steering with Volvo joystick control
 - adjustable steering wheel
 - high-speed magnetic compass
 - electronic engine controls
 - trim tab controls with indicators
 - bow thruster control
 - electric anchor winch remote control
 - autopilot (incorporated into 16" screen at both control positions)
 - speed and distance log (incorporated into 16" screen at both control positions)
 - echo sounder with alarm
 - VHF with DSC R/T with intercom
 - remote control searchlight
 - horn button

- teak footrest

- Drinks holders
- Toughened glass screen (clear for night vision)
- Windscreen wipers with freshwater windscreen wash
- Black mesh sunscreens
- Bilge pump controls with visual pump running warnings
- 24v and 240v electrical control panel
- Riding light, helm and navigation light control switches
- Twin USB connection point (was single)
- LED overhead lighting (24v) and night lighting
- Electric drop window
- Fitted carpet

DECK SALOON

- U-shaped sofa
- Folding leaf dining table or coffee table
- Electric drop window (port)
- Two-seater sofa
- Crockery storage drawer
- Sideboard unit
- UHD LED TV (50") on rise and fall
- Apollo MS-RA670 audio system, with WiFi/DAB and external USB socket. Paired with Fusion 6"

MS-CL602 speakers (2)

- Blinds or sunscreens to all windows and doors
- LED overhead and concealed lighting (24v)
- Access stairway to lower accommodation
- Fitted carpet

GALLEY

- Solid Surface counter top in Sylmar white
- Ceramic 4-zone hob
- Hob extractor
- Combination microwave/convection oven with grill
- Stainless steel sink with mixer tap
- Full height fridge/freezer (270l)
- Waste bin
- Drawers and storage cupboards
- Sideboard unit with bottle and glass storage
- Refrigerator
- Stainless steel framed sliding door to cockpit with integrated hinging window aft of galley
- Blinds or sunscreens to all windows and doors
- LED overhead and task lighting (24v)
- 220/240v outlets (4)
- Timber-laid flooring

ACCOMMODATION

- All cabins and bathrooms feature opening portholes
- All cabins feature 220/240v power points
- All bathrooms feature electric freshwater toilets and 240v shaver points

MASTER STATEROOM

- Large double bed with drawers below
- Twin bedside tables
- Wardrobe with shelves and mirror
- Dressing table
- Pull out mirror to vanity unit
- Occasional table with seats fore and aft
- Storage lockers and drawers
- Fusion MS-SRX400 paired with Fusion 6" MS-CL602 speakers (2)
- Panoramic windows including opening porthole with venetian blinds
- LED overhead and concealed lighting (24v)
- Individual berth lights
- 220/240v outlets (2)
- USB connection points (at each berth) (2)
- Fitted carpet
- En-suite bathroom
- Wash basin with Solid Surface vanity top

- Mirror
- Storage lockers
- Shower compartment with automatic pump out
- Extractor fan
- Window with opening porthole and venetian blind
- LED overhead and concealed lighting (24v)
- Bathroom accessories
- Solid Surface flooring

FORWARD STATEROOM

- Large double bed with drawers below
- Wardrobe with shelves and mirror
- Dressing table
- Mirror to vanity unit
- Storage lockers
- Window with opening porthole and venetian blind
- Deck hatch
- LED overhead and concealed lighting (24v)
- Individual berth lights
- 220/240v outlets (2)
- USB connection points (at each berth) (2)
- Fitted carpet
- En-suite bathroom
- Wash basin with Solid Surface vanity top

- Mirror
- Storage lockers
- Shower compartment with automatic pump out
- Extractor fan
- Window with opening porthole and venetian blind
- LED overhead and concealed lighting (24v)
- Bathroom accessories
- Solid Surface flooring

STARBOARD GUEST CABIN

- Two single beds with drawers below (with option of double bed conversion)
- Bedside table
- Wardrobe with shelves
- Mirror
- Storage lockers and drawers
- Window with opening portholes and venetian blind
- LED overhead and concealed lighting (24v)
- Individual berth lights
- 220/240v outlets (2)
- USB connection points (at each berth) (2)
- Fitted carpet

OPTIONAL AFT CABIN (IN PLACE OF AFT LAZARETTE)

- Single bed with storage below
- Wardrobe with shelf
- Mirror
- LED overhead lighting (24v)
- Individual berth lights
- 220/240v outlet (1)
- Fitted carpet
- En-suite bathroom
- Wash basin with Solid Surface vanity top (in main cabin area)
- Storage lockers
- Opening porthole
- Shower with automatic pump out
- Extractor fan
- LED overhead lighting (24v)
- Bathroom accessories

POWER AND DRIVE SYSTEMS

- 5-bladed propellers in nickel aluminum bronze
- Bow thruster is 130kgf/286lbf with dual-station controls
- Engine room lighting
- Engine room access hatch and ladder
- Power-assisted electro-hydraulic steering

- system
- Trim tabs with indicators
- Electronic engine and gear shift controls
- Engine room extractor fans with electronic time delay
- Fresh water supply point in engine room
- Dripless self-aligning shaft seals

ELECTRICAL SYSTEMS

24 Volt:

- 4 x heavy duty batteries for engine starting
- 4 x heavy duty auxiliary batteries
- Battery link facility with remote control at helm position
- Both battery banks are charged using a voltage sensitive relay that parallels both battery banks when a charging source is present
- 60-amp battery charger
- Remote battery master switches with control switch at main switch panel
- Circuit breakers on all circuits
- 12v voltage dropper for certain navigation and radio circuits

220/240 Volt:

- 9.5Kw diesel generator in own sound shield with water cooled specially silenced exhaust
- Automatic fire extinguisher situated in the engine room
- 50-amp shore support inlet
- Generator/shore support change-over switch
- Polarity check system
- Earth leakage safety trip
- Circuit breakers on all circuits
- Power points in: Owner's stateroom, guest cabins, galley and saloon area
- Shaver points in all bathrooms

FUEL SYSTEM

- Twin fuel tanks (in NS8 marine grade alloy) with interconnection system giving 605 gal/726 US gal/2,750l capacity
- Fuel fillers on port and starboard side decks
- High-capacity duplex fuel filters with water traps with change-over valves
- Water warning sensors connected to warning lights at lower helm
- Remote fuel cocks in cockpit locker
- Fuel gauges at main helm console

WATER SYSTEM

- Water tanks totalling 136 gal/164 US gal/620l plus 16 gal/19 US gal/73l hot water calorifier
- Water heated by engines and 240v immersion heater
- Automatic water pump with filter
- Main circuit breaker at switch panel
- Water level gauge
- Deck filler
- Electric freshwater toilet system with 69 gal/83 US gal/315l holding tank, content gauge and manual overboard discharge, with macerator backup system as well as dockside discharge system

FIRE EXTINGUISHERS

- Automatic/manual override fire extinguishers in engine room with warning system at helm position
- Hand-operated fire extinguishers (5) in owner's stateroom, forward and starboard guest cabin, galley and helm position
- Additional extinguisher fitted when optional aft cabin is specified

BILGE PUMPS

- Automatic/manual override electric bilge pumps in engine room (2), lazarette and forward accommodation (5 in all)
- High-capacity manual bilge pump with valve system and suction points in same areas
- Electric bilge pumps have controls and warning lights at main helm and warning light with audible alarm at flybridge helm

OTHER STANDARD EQUIPMENT

- Ensign staff
- Fenders (6)
- Mooring warps (4)
- Boat hook
- First Aid kit
- Tool kit
- Owner's manual and engine manual
- Quilted bedspreads supplied to all cabins (except optional crew cabin)
- Ship's document case
- Anchor winch back up handle

FINISHES

- Teak-laid decks to transom platform, steps to side decks, cockpit deck and steps to flybridge
- Timber-laid floor to galley area
- Furniture in choice of Rovere oak or Alba oak in satin lacquer finish as standard. Silver oak or walnut in satin or gloss lacquer finishes available as an option.
- Solid Surface floors in all bathroom suites in guest accommodation
- Solid Surface wash basin and counter tops in all bathrooms
- Galley counter top in Solid Surface finish
- Exterior flybridge helms seat upholstery in Comfort Exterior as standard
- Additional exterior upholstery in white vinyl as standard, with optional upgrade to Comfort Exterior available
- Choice of high-quality carpet and upholstery fabric from extensive range
- Blinds or sunscreens to all windows and portholes
- Optional crew cabin has carpet and crew bathroom has white Solid Surface vanity tops and GRP flooring

F50



Featuring the latest F Class exterior styling, and advanced technology on-board, the F50 flybridge yacht delivers dynamic performance at sea.

The F50 features a sophisticated standard of refinement with contemporary finishes and handcrafted elements throughout. The sociable cockpit leads through to the main saloon, with open galley aft and large U-shaped sofa and dining table for six guests.





Guests are accommodated on-board across three beautifully appointed cabins, two of which are en-suite. The spacious full-beam master stateroom invites relaxation, with a double bed, sofa and dressing area. The generous en-suite forward stateroom includes a large double bed with the option of scissor berths to provide flexibility for guests.

New technology is available on-board, including Gyro stabilizers and Volvo Penta Easy boating as an option to complement the F50's advanced resin-infused hull and efficient twin Volvo D8-IPS 800 (2 x 600mhp) engines which provide speeds up to 34 knots.





TAKE A VIRTUAL TOUR OF THE F50



F50
SPECIFICATION

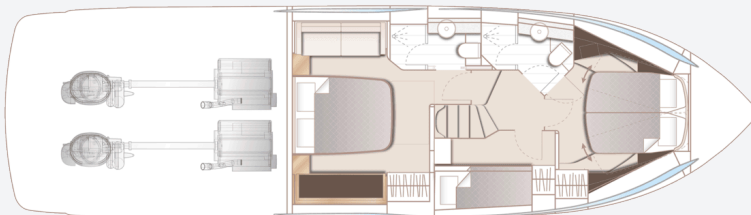
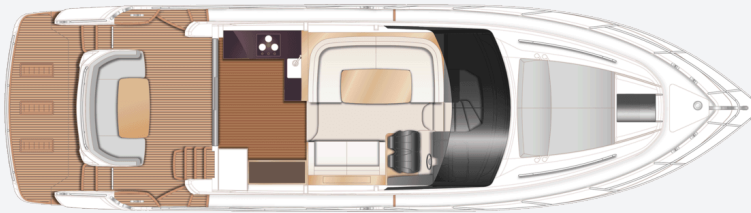
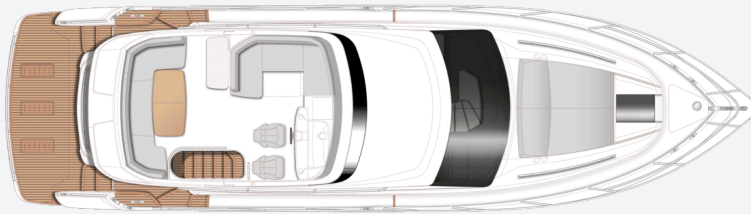

PRINCIPAL DIMENSIONS

Length overall (incl. pulpit)	51ft 4in (15.65m)
Length overall (excl. pulpit)	49ft 8in (15.14m)
Beam	14ft 1in (4.30m)
Draft (at full load) approx.	4ft 7in (1.39m)
Displacement approx.	22,893kg (50,471lbs)*
Fuel capacity	406 gal/488 US gal/1,850l
Water capacity (excl. calorifier)	92 gal/111 US gal/ 420l

ENGINES

Twin Volvo D8 IPS 800 (2 x 600hp)	Speed range: 32-34 knots†
--	------------------------------

FULL SPECIFICATION

DECK FITTINGS

- Teak-laid transom platform, cockpit deck, flybridge stairway and steps to side deck
- Reversible electric anchor winch with foredeck, main helm and flybridge controls
- Stemhead roller with automatic anchor launch and retrieve
- Self-stowing galvanised Lewmar Delta anchor (20kg/44lbs) with flush pin shackle and 40m of 9.5mm chain
- Deck hatch access to chain locker
- Fender storage
- Stainless steel bow and stern fairleads
- Stainless steel bow, stern and spring cleats
- Stainless steel pulpit and guard rails
- Stainless steel coachroof and flybridge handrails
- Foredeck hatch
- PVC rubbing band with stainless-steel insert
- LED deck level lighting
- Illuminated crown logo to transom
- Full set of IMCO navigation lights
- Riding light

- Twin beam searchlight with dual station remote controls
- Twin electric horns
- Fuel and water fillers
- Foredeck sunbed recess

COCKPIT AND BATHING PLATFORM

- Self-draining
- U-shaped seating/dining area with folding teak table
- LED overhead and deck level lighting
- Stainless steel handrails
- Lockable gas strut assisted hatch to engine room/lazarette
- Liferaft stowage locker
- Storage lockers
- Locker containing remote fuel cocks, manual bilge pump with valve chest and manual controls for automatic fire extinguishers
- Integral stairway to flybridge with teak step treads
- Twin transom gates leading to bathing

platform

- Hot and cold transom shower
- 220/240v shore support inlet
- Cockpit canvas cover
- Transom hatch to stern lazarette
- Transom bathing platform with fold away swimming ladder (electro-hydraulic raise/lower mechanism for transom platform (450kg SWL) is optionally available)

FLYBRIDGE

- Dual station instruments and controls
- Autopilot controls
- Adjustable steering wheel
- Audible and visual alarm for bilge pumps and water in fuel
- Twin helm seats with fore and aft adjustment for helmsman
- Refrigerated top loading coolbox
- Large U-shaped upholstered seating
- Folding teak table
- L-shaped seat (converts to sunbed)

- Fusion Apollo marine stereo system connected to Fusion 7.7" waterproof speakers (2)
- Clear view hatch to aft cockpit
- Wind deflector screens
- Stainless steel handrails
- LED deck level lighting
- GRP radar arch
- Twin matching whip aerials for VHF R/T and radio
- Console and seat covers
- Optional wetbar with barbecue, sink, waste bin and storage
- Optional bimini

HELM POSITION

- Double leather upholstered helm seats
- Console with 16" Volvo/Garmin display incorporating engine instruments and chartplotter
- Dual station instruments and controls at flybridge and lower helm positions:
 - power-assisted steering
 - adjustable steering wheel
 - rudder position indicator
 - high-speed magnetic compass

- electronic engine controls
- joystick control
- trim tab controls with indicators
- electric anchor winch remote control
- speed and distance log (incorporated into 16" screen at lower control position)
- echo sounder with alarm (incorporated into 16" screen at lower control position)
- autopilot
- VHF with DSC R/T and intercom
- remote control searchlight
- horn button
- Drinks holders
- Toughened glass screen (clear for night vision)
- Windscreen wipers with freshwater windscreen wash
- Exterior black mesh windscreen covers
- Bilge pump controls with visual pump running warnings
- 24v and 240v electrical control panel
- Riding light, helm and navigation light control switches
- USB connection point (1)
- LED overhead lighting (24v) and night lighting

- Opening window adjacent to helmsman
- Fitted carpet

DECK SALOON

- Triple stainless steel framed sliding door to cockpit
- U-shaped sofa to port
- Dining table
- Two-seater sofa to starboard
- Fusion Apollo marine audio system connected to Fusion 6" CL602 speakers (2)
- Manual tension Venetian blinds or curtains to all windows
- LED overhead lighting (24v)
- Stairway to lower accommodation
- Fitted carpet

GALLEY

- Solid Surface countertop
- 3-zone ceramic hob
- Extractor fan
- Combination microwave/convection oven with grill
- Stainless steel sink with mixer tap
- Chopping board
- Refrigerator with freezer compartment

(155l)

- Optional full height fridge/freezer (270l)
- Waste bin
- Drawers and storage cupboards
- Dedicated crockery and cutlery storage
- Full height larder unit
- Sideboard with storage, drinks fridge and provision for optional ice maker
- Bottle and glassware storage
- Manual tension venetian blinds or curtains to all windows and doors
- LED overhead and task lighting (24v)
- 220/240v outlets (4)
- Timber flooring (V-groove planked)

ACCOMODATION

- All cabins and bathrooms feature opening portholes
- All cabins feature 220/240v power points
- All bathrooms feature electric freshwater toilets and 240v shaver points
- Main companionway has storage space below with option for combination washer/dryer

OWNER'S STATEROOM

- Large double bed with drawers below
- Twin bedside tables
- Wardrobe with shelves
- Dressing table
- Mirror
- Sofa
- Storage lockers and drawers
- Panoramic windows including opening portholes
- Manual tension venetian blinds
- LED overhead lighting (24v)
- Individual berth lights
- 220/240v outlets (2)
- Fitted carpet

EN-SUITE BATHROOM

- Wash hand basin with Solid Surface vanity top
- Mirror
- Storage lockers
- Shower compartment with automatic pump out
- Extractor fan
- Window with opening porthole
- Manual tension venetian blind
- LED overhead lighting (24v)

- Bathroom accessories
- Solid Surface flooring

FORWARD STATEROOM

- Large double bed with drawers below (option of scissor berths)
- Wardrobe with shelves
- Dressing table
- Mirror
- Storage lockers and drawers
- Window with opening porthole
- Manual tension venetian blind
- Deck hatch with integrated skylight and blind
- LED overhead lighting (24v)
- Individual berth lights
- 220/240v outlets (2)
- Fitted carpet

EN-SUITE BATHROOM

- Wash hand basin with Solid Surface vanity top
- Mirror
- Storage lockers
- Shower compartment with automatic pump out

- Extractor fan
- Window with opening porthole
- Manual tension venetian blind
- LED overhead lighting (24v)
- Bathroom accessories
- Solid Surface flooring

STARBOARD GUEST CABIN

- Two single bunk beds
- Wardrobe with shelves
- Mirror
- Storage lockers
- Window with opening porthole
- Manual tension venetian blinds
- LED overhead lighting (24v)
- Individual berth lights
- 220/240v outlets (2)
- Fitted carpet

POWER AND DRIVE SYSTEMS

- Twin Volvo IPS contra rotating propellers via pod drive
- Engine room lighting
- Engine room access hatch and ladder
- Power-assisted electronic steering system with hydraulic back-up

- Trim tabs with indicators
- Electronic engine controls
- Joystick manoeuvring system
- Volvo IPS active corrosion protection system for pod drive
- Engine room extractor fan with electronic time delay

ELECTRICAL SYSTEMS

24 Volt:

- 4 x heavy-duty batteries for engine starting
- 4 x heavy-duty auxiliary batteries
- Battery link facility with remote control at helm position
- Both battery banks are charged using a voltage sensitive relay that parallels both battery banks when a charging source is present
- 40-amp 24v battery charger
- Remote battery master switches with control switch at main switch panel
- Circuit breakers on all circuits
- 12v voltage dropper for certain navigation and radio circuits

220/240 Volt:

- 4 kW generator in own sound shield with water cooled specially silenced exhaust
- Automatic fire extinguisher
- 50-amp shore support inlet
- Polarity check system
- Earth leakage safety trip
- Circuit breakers on all circuits
- Power points (240v) in: owner's stateroom, guest cabins, galley and saloon area
- Shaver points in all bathrooms

FUEL SYSTEM

- Fuel tanks (in NS8 marine grade alloy) with interconnection system giving 406 gal/488 US gal/1,850l capacity
- Fuel fillers on port and starboard side decks
- High-capacity Simplex fuel filter with water trap and change-over valves, water warning sensor connected to audible and visual warning lights at both helm stations
- Remote fuel cocks in cockpit locker
- Fuel gauges at both helm stations

WATER SYSTEM

- Water tanks totalling 92 gal/111 US gal/420l plus 9 gal/11 US gal/45l hot water calorifier

- Water heated by engines and 240v immersion heater
- Automatic water pump with filter
- Pump main circuit breaker at AC/DC switch panel
- Water level gauge
- Deck filler
- Electric freshwater toilet system with holding tank, contents gauge and manual overboard discharge as well as dockside discharge system

EXTINGUISHERS / FIRE CONTROL SYSTEMS

- Automatic/manual override fire extinguishers in engine room with warning system at flybridge and lower helm positions
- Hand operated fire extinguishers (5) in owner's stateroom, forward stateroom, starboard guest cabin, galley and lower helm position
- BILGE PUMPS
-
- Automatic/manual override electric bilge pumps in engine room (2) and forward accommodation (4 in all)

- High-capacity manual bilge pump with valve system and suction points in same areas
- Electric bilge pumps have controls and warning lights at main helm and warning light with audible alarm at flybridge helm

OTHER STANDARD EQUIPMENT

- Ensign staff
- Fenders (6)
- Mooring warps (4)
- First Aid kit
- Tool kit
- Owner's manual and engine manual
- Quilted bedspreads supplied to all cabins
- Ship's document case
- Anchor winch back up handle

FINISHES

- Teak-laid decks to transom platform, cockpit deck, steps to side decks, steps to flybridge
- Timber-laid floor to galley (V-groove planked)
- Furniture in choice of Rovere oak or Alba oak wood with satin finish as standard. Silver oak or walnut wood with satin or

- gloss finishes available as an option
- Galley in specified choice of boat timber with option for lower portside galley units to be in HPL soft matt feel finish
- Solid Surface floors in all bathroom suites in guest accommodation
- White Solid Surface vanity tops in all bathroom suites in guest accommodation
- White Solid Surface galley countertop
- Choice of high-quality carpet and upholstery fabric from extensive range
- Curtains, manual tension blinds or sunscreens to all windows and portholes



F 45



The exceptional F45 flybridge delivers unparalleled space, quality and flexibility for the ultimate on-water experience. Her extended flybridge includes a seating area with teak dining table and forward L-shaped seats that convert to a sunpad when required. At the touch of a button, her unique, electrically-sliding transom seating arrangement extends the length of the cockpit area to deliver unrivalled main deck space for a 45ft yacht.





Below deck, a full beam owner's cabin complemented by a forward en-suite cabin await and exceed your accommodation expectations belying her sleek proportions. Powered by Volvo IPS 600's and reaching a top speed of up to 31 knots, the F45 is a breathtakingly beautiful craft. Together with its elegant full-length hull windows, beautifully resolved surfacing, and unusual design detail, the F45 establishes itself as the pinnacle of small flybridge yachts.





TAKE A VIRTUAL TOUR OF THE F45



F45
SPECIFICATION

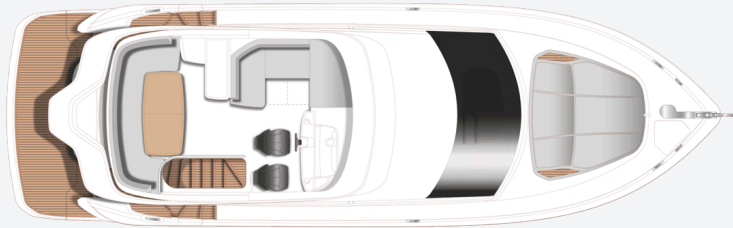

F45 Flybridge

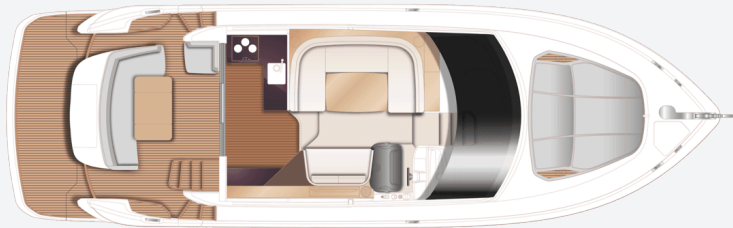

F45 Main Deck



F45 Lower Deck

PRINCIPAL DIMENSIONS

Length overall (incl. pulpit)	47ft 1in (14.35m)
Length overall (excl. pulpit)	44ft 9in (13.64m)
Beam	14ft 0in
Draft	3ft 7in (1.09m)
Displacement approx. (half load)	19,040kg (41,976lbs)*
Fuel capacity	370 gal/ 445 US gal/1,684l
Water capacity (incl. calorifier)	107 gal/129 US gal/

ENGINES

Twin Volvo IPS 600 (2 x 440mhp)	Speed range: 29-31 knots†
--	------------------------------------

FULL SPECIFICATION

DECK FITTINGS

- 6mm teak-laid transom platform, cockpit deck, flybridge stairway and steps to side decks
- Lewmar reversible electric anchor winch with foredeck, main helm and flybridge controls
- Stem head roller with automatic anchor launch and retrieve
- Self-stowing 20kg/35lbs Delta anchor with 40m of chain
- Deck hatch access to chain locker
- Fender storage
- Stainless steel bow fairleads
- Stainless steel bow, stern and spring cleats
- Stainless steel pulpit and guard rails
- Stainless steel coach roof and flybridge handrails
- Foredeck escape hatch
- Foredeck sunbathing area
- PVC rubbing band with stainless steel insert
- LED deck level lighting
- Illuminated crown logo on transom
- Full set of IMCO navigation lights
- Riding light

- Searchlight with dual station remote controls
- Twin electric horns
- Fuel and water fillers
- Holding tank dockside discharge connection
- Ensign socket and staff

COCKPIT AND BATHING PLATFORM

- Self-draining
- L- shaped upholstered seating
- Teak folding table
- Upholstered aft facing seat with locker containing remote fuel cocks, manual bilge pump with valve chest and manual controls for automatic fire extinguisher
- Transom seat locker
- LED overhead and deck level lighting
- Stainless steel handrails
- Lockable gas strut assisted hatch to engine room/lazarette
- Life raft stowage locker
- Open rope storage lockers
- Integral stairway to flybridge with teak step treads

- Transom gates leading to bathing platform
- Transom bathing platform with foldaway swimming ladder (will fit a tender up to 2.9m)
- Optional electro-hydraulic raise/lower mechanism for transom platform (400kg SWL - maximum advised tender weight 300kg) including dinghy chock system
- 220/240v shore support inlet
- Hot and cold transom shower
- Cockpit canvas cover

FLYBRIDGE

- Dual station instruments and controls (Helm Position)
- Adjustable steering wheel
- Audible and visual alarm for bilge pumps
- Twin helm seats with fore and aft adjustment for helmsman
- Large U-shaped upholstered seating
- Forward L-shaped seat (converts to sunpad)
- Folding teak table
- JL Audio M6-650X-L Waterproof speakers (2) linked to saloon audio system

- Clear view hatch to aft cockpit
- Wind deflector screens
- Stainless steel handrails
- LED deck level lighting
- Wireless waterproof phone charger
- GRP radar arch
- Console and seat covers
- Twin matching whip aerials for VHF R/T and radio
- Optional wet bar with electric barbecue with refrigerated top loading cool box
- Optional bimini

HELM POSITION

- Double leather upholstered helm seat with manual fore and aft adjustment
- Dual station instruments and controls at Flybridge and Lower Helm Positions:
 - power steering
 - adjustable steering wheel
 - high-speed magnetic compass
 - electronic engine controls with integrated automatic trim tab control
 - Joystick control
 - electric anchor winch remote control
 - 16" Volvo/Garmin display with audible and

- visual engine data and warning, autopilot control, speed and distance log, echo sounder, auto trim tab position and rudder reference
- VHF with DSC R/T with intercom
- remote control searchlight
- horn button
- Drinks holders
- Toughened glass screen (clear for night vision)
- Windscreen wipers with freshwater windscreen wash
- Exterior black mesh windscreen covers
- Bilge pump controls with visual pump running warnings (with audible alarm at upper helm)
- 24v and 240v electrical control panel
- Riding light, helm and navigation light control switches
- USB charging point (1)
- LED overhead lighting (24v) and night lighting
- Manual sliding tinted side window adjacent to helmsman
- Fitted carpet

SALOON

- Triple stainless steel framed sliding doors to aft cockpit (3 panes total, 2 opening)
- U-shaped sofa with dining table to port (option

- for double berth conversion)
- Two-seater sofa
- Drawer storage below sofas
- Fusion MS-RA770 audio system connected to speakers (2)
- Venetian blinds to all windows and doors
- LED overhead lighting (24v)
- Stairway to lower accommodation
- Fitted carpet

GALLEY

- Sylmar White (satin finish) solid surface counter top
- 3-zone diesel fuelled hob (option of electric hob and fitted as standard when generator selected)
- Extractor fan
- Combination microwave/convection oven with grill
- Stainless steel sink with mixer tap
- Twin refrigerator with removable freezer compartments
- Waste bin
- Chopping board
- Drawers and storage cupboards
- Manual tension venetian blinds to window

- LED overhead and task lighting (24v)
- 220/240v outlets
- Provision for optional dishwasher
- Timber flooring (V groove planked)

ACCOMMODATION

- All cabins and bathrooms feature opening portholes
- All cabins feature 220/240v power points
- All bathrooms feature electric freshwater toilets and 240v shaver points

OWNER'S STATEROOM

- Large double bed with drawers below
- Bedside tables
- Wardrobes with shelves
- Mirror
- Sofa
- Storage lockers and drawers
- Panoramic windows including opening portholes
- Manual tension venetian blinds to hull windows
- LED overhead (24v)
- Individual berth lights
- 220/240v outlets (2)
- USB charging point (1)

- Fitted carpet

EN-SUITE BATHROOM

- Wash basin with Carrera White (gloss finish) solid surface counter top
- Mirror
- Storage lockers
- Shower compartment with automatic pump out
- Extractor fan
- Opening porthole Manual tension venetian blind
- LED overhead lighting (24v)
- Bathroom accessories
- Koko White (satin finish) solid surface flooring

FORWARD GUEST CABIN

- Large double bed with drawers below (option of scissor berths)
- Wardrobe with shelves
- Dressing table
- Mirror
- Storage lockers and drawers
- Opening porthole
- Manual tension venetian blind
- Deck hatch
- LED overhead (24v)
- Individual berth lights

- 220/240v outlets (2)
- USB charging point (1)
- Fitted carpet

EN-SUITE BATHROOM

- Wash basin with Carrera White (gloss finish) solid surface counter top
- Mirror
- Storage lockers
- Shower compartment with automatic pump out
- Extractor fan
- Opening porthole and venetian blind
- LED overhead lighting (24v)
- Bathroom accessories
- Koko White (satin finish) solid surface flooring
- Day access door from passageway

POWER AND DRIVE SYSTEMS

- Twin Volvo IPS (2 x 440 or 480mhp driving contra rotating propellers via pod drive) with integral power-assisted steering system with automatic trim tabs
- Engine room lighting
- Engine room access hatch and ladder
- Electronic engine controls
- Joystick manoeuvring system

- Volvo IPS active corrosion protection system for pod drive
- Engine room extractor fan with electronic time delay

ELECTRICAL SYSTEMS

24 Volt:

- 4 x heavy-duty batteries for engine starting
- 4 x heavy-duty auxiliary batteries
- Battery link facility with remote control at helm position
- All battery banks are charged using a voltage sensitive relay that parallels all batteries banks when a charging source is present
- 40-amp 24v battery charger
- Remote battery master switches with control switch at main switch panel
- Circuit breakers on all circuits
- 24v to 12v voltage dropper for certain navigation and radio circuits

220/240 Volt:

- Shore support inlet
- Polarity check system
- Earth leakage safety trip
- Circuit breakers on all circuits

- Power points (240v) in: owner's stateroom, guest cabin, galley and saloon area
- Shaver points in all bathrooms

FUEL SYSTEM

- Twin fuel tanks (in NS8 marine grade alloy) with interconnection system giving 286 gal /343 US gal / 1,300 l capacity
- Fuel fillers on port and starboard side decks
- High-capacity fuel filter with water trap and change-over valves, water contamination warning integrated with engine data display
- Remote fuel cocks in cockpit seat locker
- Fuel levels integrated with engine display data

WATER SYSTEM

- Water tank of 100 gal /120 US gal / 455l plus 7 gal /8 US gal / 32 l hot water calorifier giving a total of 107 gal / 129 US gal / 487l water capacity.
- Water heated by engines and 240v immersion heater
- Automatic water pump with filter
- Main circuit breaker at switch panel
- Water level gauge
- Deck filler

- Electric freshwater toilet system with 33 gal / 40 US gal / 150l holding tank, contents gauge, manual overboard discharge and dockside discharge.

FIRE EXTINGUISHERS

- Automatic/manual override fire extinguishers in engine room with warning system at flybridge and lower helm position
- Hand operated fire extinguishers (4) in owner's stateroom and forward guest cabin, galley and lower helm position

BILGE PUMPS

- Automatic electric bilge pumps (with manual override) in engine room (2) and forward accommodation (2)
- High-capacity manual bilge pump with valve system and suction points in same areas
- Electric bilge pumps have controls and warning lights at main helm and warning light with audible alarm at flybridge helm

OTHER STANDARD EQUIPMENT

- Ensign staff
- Fenders (6)

- Mooring warps (4)
- First aid kit
- Tool kit
- Owner's manual and engine manual
- Quilted mattress cover supplied to all cabins
- Ship's document case
- Boat hook
- Anchor winch back up handle

FINISHES

- Teak-laid decks to transom platform, steps to side decks and steps to flybridge
- Timber-laid V groove planked floor to galley
- Furniture in choice of Rovere Oak or Alba Oak in satin finish as standard. Silver Oak or Walnut in satin or gloss finishes available as an option.
- Solid surface floors in all bathroom suites
- Solid surface wash basin counter tops in all bathroom suites
- Galley counter top in solid surface
- Galley furniture in soft-touch grey surface matt finish
- Choice of high-quality carpet and fabrics from the Quartz range
- Blinds or sunscreens to all windows and portholes



SAFEGUARDING YOUR SANCTUARY

Your yacht is your haven, so the wellbeing of you and your family is of upmost importance to us. That's why we offer the option of the 'Princess Lifeline' powered by MedAire. A 24/7 SOS service providing access to medical and security assistance. One phone call connects you to MedAire's team of over 200 global security experts and 80,000 accredited medical providers who can assist you in the event of a medical or travel safety emergency. You can relax on board knowing everything is taken care of.



OUR PARTNERS

Princess is proud to partner with a few exclusive brands who share our vision and brand values, and deliver exceptional experiences to their customers.



To celebrate our 50th anniversary, **SEABOB** created a Limited Edition collection which was the start of a unique relationship with this successful marine brand. The success of our 50th anniversary limited edition SEABOB marked the start of a unique relationship with this successful marine brand. We have since collaborated on a collection of limited edition designs as the perfect complement to your Princess yacht.



As we evolve our technology offering on each and every Princess, our partnership with **NAIM** provides world class audio visual systems that continue to rewrite the audiophile rule book.



Princess was honoured to become the first luxury yacht manufacturer to officially collaborate with **The Marine Conservation Society**. It's our way to support and sustain marine ecology, securing an environment for future generations to discover and explore.



With a shared passion for sustainability and ocean conservation, we recently partnered with **Ecoworks Marine** to help tackle the challenge of creating a more environmentally friendly approach to yacht cleaning. In a first for the industry, Ecoworks Marine have developed their 'Preserve the Living Seas' range, a unique collection of cleaning products that are fully biorenewable, quickly biodegradable and sustainably formulated.



Williams Jet Tenders are our provider of choice, with every Princess yacht designed to accommodate the models in their range.



We are proud partners of the **Salcombe Distilling Company**. Inspired by the coastal vitality of Salcombe and its shipbuilding heritage, Salcombe Distilling Co. creates exceptional spirits at its waterside distillery on Island Street, Salcombe; one of the world's only distilleries directly accessible by boat. The partnership will see Princess Yachts and Salcombe Distilling Co. collaborate at events around the world.



RECOGNITIONS

Our priority is to be considered the best by our owners, but recognition by independent experts through a number of prestigious awards has given Princess and our craftspeople a tremendous sense of pride.



Oceanway China Yacht Awards

Best of the Year 24-30m Superyacht

Most Popular Award 24-30m

X95

2022

Oceanway China Yacht Awards

Best Layout 60-80ft motor yacht

Y72

2022

Oceanway China Yacht Awards

Best Layout 45-60ft motor yacht

F45

2022

Motor Boat Awards

Best Flybridge up to 60ft

F45

2022

Motor Boat Awards

Best Flybridge over 60ft

Y72

2022

Robb Report

Best of the Best Yacht

X95

2021

IBI Boat Builder Awards

Best Apprenticeship Scheme

Princess Royal Training Award

Apprentice Scheme

2020

World Yachts Trophies

Best Shipyard

2019

The Sunday Times Profit Track**100**

Best Brand Award

Princess Yachts Limited

2019

Motor Boat Awards

Best Flybridge up to 60ft

F55

2019

Asia Pacific Boating Awards

Best Yacht Design Innovation

R35

2019

IBI Boat Builder Awards

Retail Marketing Initiative

R35 Communications Campaign

2018

World Yachts Trophies - Yachts**France**

Best Layout 45-62'

F55

2018

Asia Boating Award

Best Sports cruiser over 55ft

V65

2018

Motor Boat Awards

Sports cruisers over 45ft

S60

2018

Asia Boating Awards

Best Sports cruiser up to 45ft

V40

2017

Motor Boat Awards

Sports cruiser over 45ft

V58

2017

Motor Boat Awards

Flybridge over 55ft

75 Motor Yacht

2017

World Superyacht Awards

Semi-Displacement & Planing Two

Deck Motor Yacht

Antheya 35M

2016

Asia Boating Awards

Best Production Motor Yacht

(15m-24m)

75 Motor Yacht

2016



DISTRIBUTOR
NETWORK



With an extensive network of distributors around the globe, we are able to bring you personalised world-class service almost anywhere. We do all that we can to make sure that the process of buying a Princess is yet another exciting aspect of ownership.

Our specialist dealers have years of experience and unparalleled knowledge of our yachts. For more information on any one of the yachts in our range, please contact your local Princess office. Address and contact details can be found on our [**website**](#).

GLOBAL COVERAGE





FURTHER DETAILS

STYLING AND ACCESSORIES
SUPPLIED BY KIND PERMISSION
OF:

Anna New York
Cristal et Bronze
Cub-ar
Diptyque
Gio Bagnara
Luxury Living
Stelton
Staub
Pickett
Zwilling

PHOTOGRAPHY:

Mike Evans
Quin Bisset
George Edwards





Version 1.0

Updated April 30th 2021

* Displacements are calculated with 50% fuel and water with liferaft but with no optional equipment fitted or other gear.

† Maximum speeds will vary depending on cleanliness of hull, condition of sterngear, loading of craft, water and air temperatures, sea conditions and other factors. Speed estimates are therefore given in good faith but without warranty or liability on the part of Princess Yachts Limited. Craft illustrated in this brochure may be fitted with certain optional equipment. Specifications may be changed at any time without notice or liability.

‡ Certain specifications, which vary by model, are upgraded on Princess yachts built for use in North America. Thus, specifications and equipment will vary from the information listed in the brochure for North American Princess yachts (e.g. air-conditioning and an upgraded generator will be included as standard for all North American models and electric cooking facilities will be supplied in place of gas systems). Please consult the USA Specification Brochure for full details regarding the North American specifications for individual models.



THANK YOU

For more information or to find a distributor,
please visit our [website](#).